

A N A D I A N
HOUSE & HOME
THE MAGAZINE OF FINE LIVING

MAY/JUNE 1989 \$2.95

summer pleasures

■ City gardens ■ Backyard designs ■ Outdoor furniture ■ Lakefront living ■ French Country fare

**THOSE
WINNING
ROOMS!
OUR
NATIONAL
DESIGN
CONTEST
AWARDS
ISSUE**



lakeside pavilion

Located in the heart of Ontario's cottage country, on the shores of Lake Simcoe, this cottage was a typical example of its 1950s genre. Basically a square box, it was small and dark, offering comfort, but little aesthetic value. The owners loved their bungalow's modest profile, and didn't want to replace it, but it did need to be updated and enlarged. When they hired Toronto architect John Hix to renovate the property, the clients imposed minimal design instructions: keep it scaled to cottage-country traditions. The last thing they wanted was a transplanted suburban ranch posing as a cottage.

To meet the family's need for more space, Hix added a new wing with master and guest bedrooms, kitchen and outdoor decks, sauna and hot tub. A latticed facade, generously planted with vines, reconciles the new structure with the old. The architecture takes definition from its strong geometry. Tapered columns emphasize the triangular rooflines of the garage and the entry. A graceful arch lends romance to the sun-dappled deck at the front of the cottage.

Hix took a design cue from the features of the park-like setting. A wedge-shaped lot, the site widens gradually as it slopes down to the lakeshore. A stand of mature cedars borders the lush lawn. With the landscape as his

Opposite page: On a balmy summer's day the lake beckons. And the boardwalk leads the way.

Immediate right: Galley slaves, take heart. This efficient little kitchen keeps the cook and bottlewasher a part of the action.

Below right: This picturesque deck serves as an outdoor living room, enclosed only by the delicate, arched trellis.

model, the architect planned a long boardwalk as the key design element. Narrow at the entry, the path leads the visitor past the garage, widens into a spacious deck, continues through the house, where it grows into a family room, becomes an exterior deck, and finally, narrows again into a walkway down to the beach.

The boardwalk serves multiple functions: as a landscaping feature, it blends interior rooms and exterior gardens into a series of sunny galleries. Visually, it opens the interior sight lines to the dramatic vistas beyond the walls. As well, it blurs the transition between the original cottage and the new additions.

Inside, crisp, white, wide-open spaces encourage a breezily casual approach to recreational living. To incorporate the new, updated galley

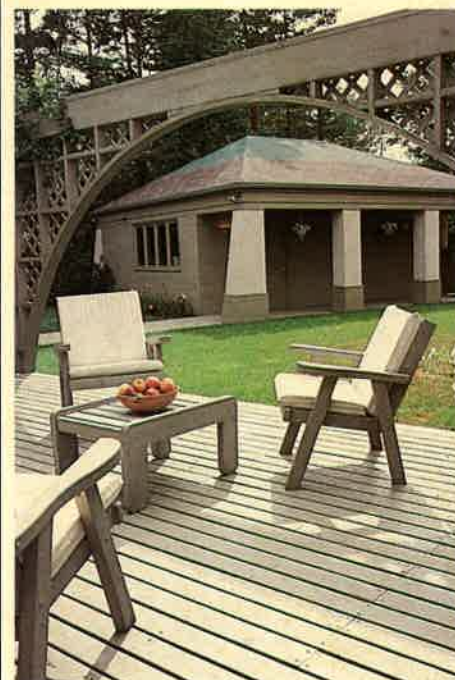

PHOTOGRAPHY BY MICHAEL MAHOVLICH

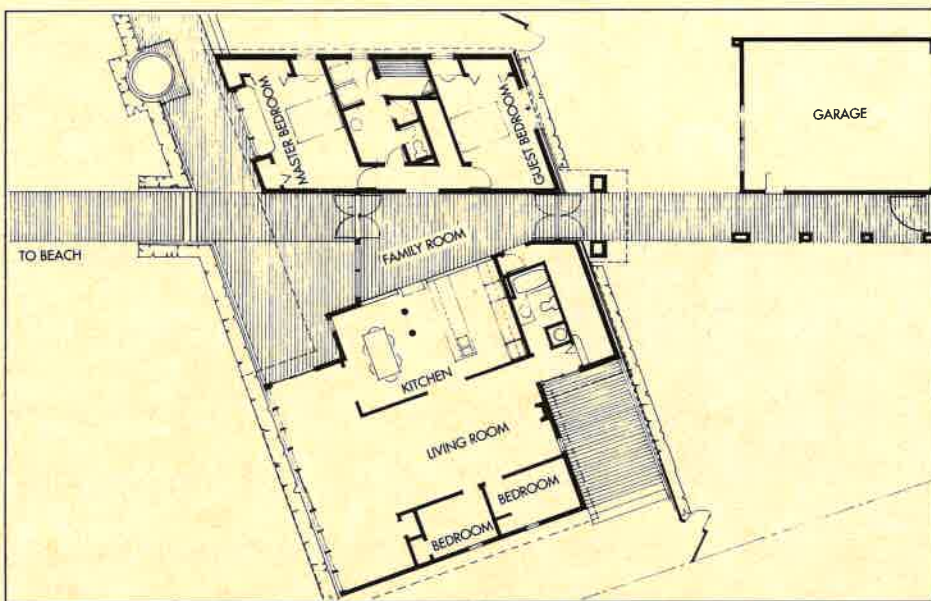

kitchen and dining area, Hix knocked out a bearing wall, replacing it with a single, elegant sculptural column. The double-width counter between kitchen and dining room invites sociable participation in food preparation. The ingenious hanging glass unit, just above the dishwasher, is a Hix signature, included in every house he designs. The owners like it so much they've borrowed the idea for their city home.

Sunny and summery, the romantic little cottage took top honours in the Ontario Renews competition. But it didn't require a certificate to convince the owners that their vacation getaway is a winner. "We spend as much time as possible here," they say. "Christmas at the cottage has become a tradition for us."

